

## Angular Contact Ball Bearings

### Brass cage angular contact ball bearing- 7305 BECBPH

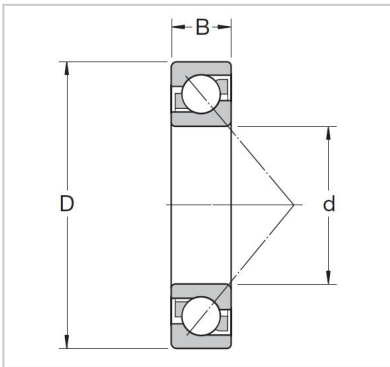

#### Abutment and fillet dimensions

Db max.	<b>7305 BECBPH</b>
Da max.	-
da min.	25
rb max.	62
ra max.	17

#### Dimensions

a	26.5
r3,4 min.	15.3
r1,2 min	0.655
D1	15 000
d2	15 000
d1	0.23

#### Mass

KG	39.8
----	------

#### Speed ratings r/min

Limiting speed	32.4
----------------	------

Reference speed	48.1
-----------------	------

#### Fatigue load limit

Pu kN	1.1
-------	-----

#### Basic load ratings KN

dynamic C kN	0.6
--------------	-----

static Co kN	26.8
--------------	------

#### Basic design bearing

B mm	32
------	----

D mm	55
------	----

d mm	57.8
------	------

Basic design bearing	1
----------------------	---

#### Designations

Universally matchable bearing	0.6
-------------------------------	-----